

# ATLAS OCEAN VOYAGES EXPLORER CLASS

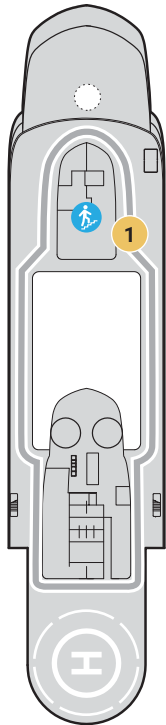

DECK 8



DECK 7

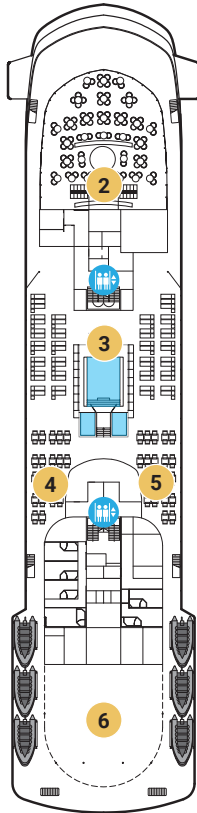

DECK 6

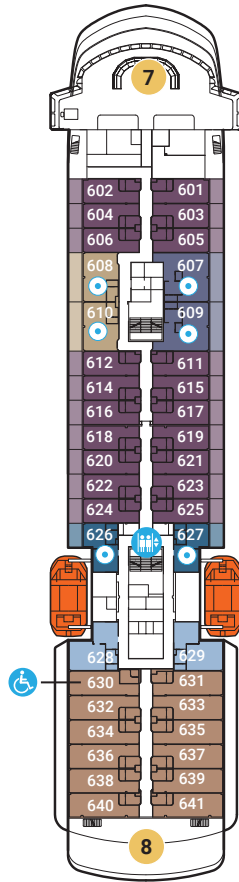

DECK 5

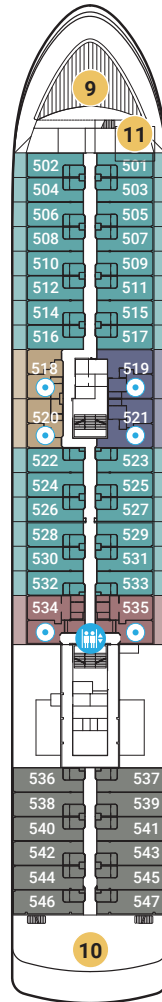

DECK 4

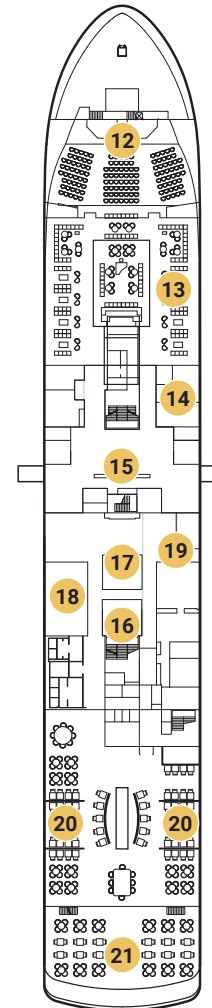

DECK 3

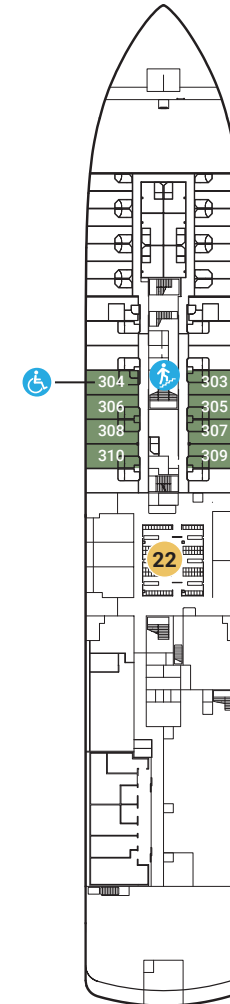

**DECK 8**

- 1 JOGGING TRACK

**DECK 7**

- 2 THE DOME OBSERVATION LOUNGE
- 3 POOL AND HOT TUBS
- 4 GRILL
- 5 POOL BAR
- 6 ZODIAC STORAGE

**DECK 6**

- 7 BRIDGE
- 8 SMALL SUNDECK

**DECK 5**

- 9 WATER'S EDGE
- 10 ZEPHYR LOUNGE
- 11 LAUNDRY †

**DECK 4**

- 12 THEATER
- 13 ATLAS LOUNGE
- 14 MEDICAL CENTER
- 15 RECEPTION
- 16 RETAIL
- 17 PAULA'S PANTRY
- 18 FITNESS CENTER
- 19 SEASPA/SAUNA
- 20 RESTAURANT
- 21 RESTAURANT

**DECK 3**

- 22 MUD ROOM

**SUITES**

- NAVIGATOR (NS)
- DISCOVERY (DS)
- JOURNEY (JS)
- SOLO (SS)

**STATEROOMS**

- HORIZON DELUXE (E1)
- VERANDA DELUXE (E2)
- HORIZON (A1)

- HORIZON (A2)
- VERANDA (B1)
- VERANDA (B2)

**SYMBOLS**

- SLEEPS 3 WITH SOFA BED
- ELEVATOR/STAIRS
- STAIRS
- ADA ACCOMMODATIONS

**SPECIFICATIONS**

- LENGTH: 129m/423'
- WIDTH: 18.9m/62'
- GROSS TON: 10,000†
- GUEST DECKS: 6
- ACCOMMODATIONS: 94
- CRUISING SPEED: 16kt/18mph

\*Effective March 22, 2022: Adventure Accommodations will be reclassified as Solo Suites.

† World Traveller & World Seeker

